

A	11/04/22	FINAL SHD SUBMISSION	PJD	MD
REV.	DATE	AMENDMENT	DRN	APPD

STATUS **FOR PLANNING
NOT FOR CONSTRUCTION**

Waterman Moylan
Engineering Consultants

BLOCK S, EASTPOINT BUSINESS PARK, ALFIE BYRNE ROAD,
DUBLIN D03 H3F4 IRELAND. Tel: (01) 654 6900
Email: info@waterman-moylan.ie www.waterman-moylan.ie

CLIENT **BIRCHWELL DEVELOPMENTS LTD**

ARCHITECT **MCCROSSAN O'ROURKE MANNING ARCHITECTS**

PROJECT **BROOMFIELD SHD**

TITLE **WATERMAIN LAYOUT SHEET 3 OF 6**

DRAWN PJD	DESIGNED RW	APPROVED MD	DATE NOV '20
SCALE 1:500 @ A1	JOB NO. 18-091	DRG. NO. P303	REVISION A

Ordnance Survey Ireland Licence
No. EN 0006022 © Ordnance Survey
Ireland/Government of Ireland.

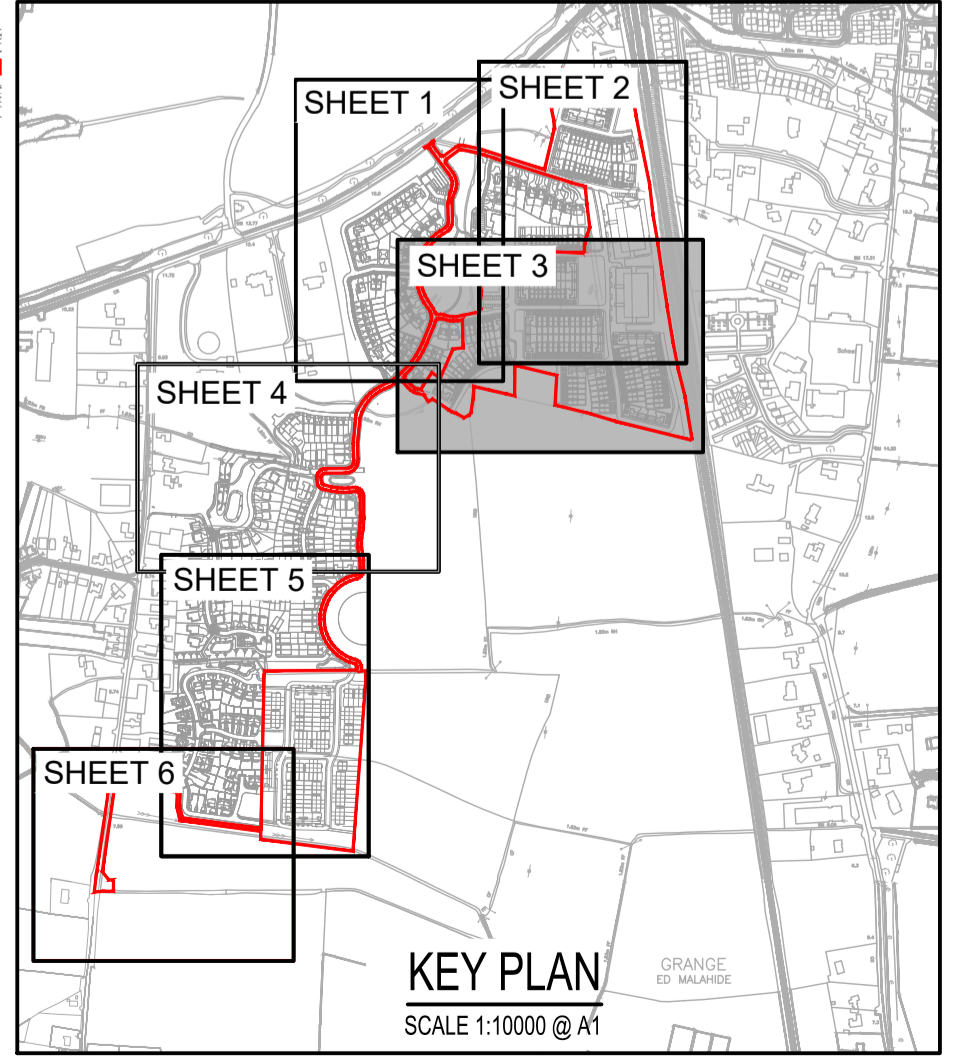
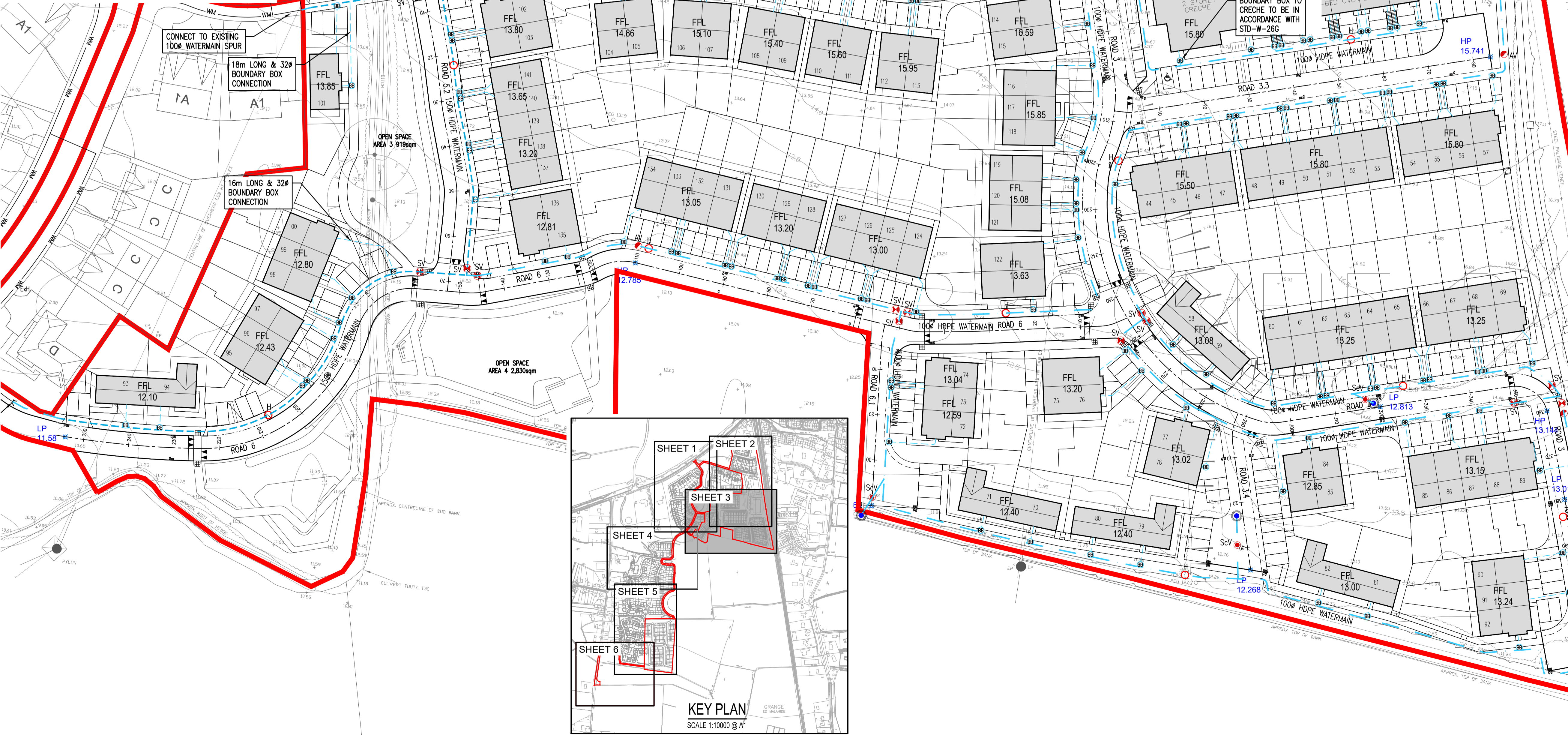
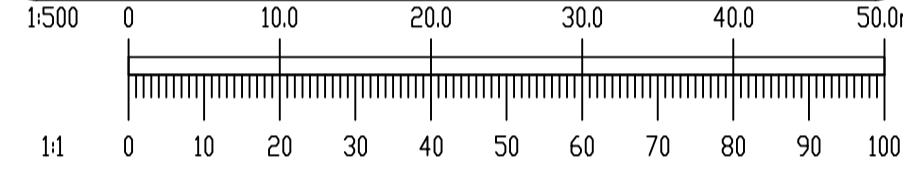

- NOTES:
- DO NOT SCALE. USE FIGURED DIMENSIONS ONLY.
 - THIS DRAWING IS TO BE READ IN CONJUNCTION WITH ALL OTHER RELEVANT ARCHITECTURAL AND ENGINEERING DRAWINGS.
 - ALL PIPE MATERIALS SHALL BE IN ACCORDANCE WITH SECTION 3.9 OF THE IRISH WATER CODE OF PRACTICE FOR WATER INFRASTRUCTURE. WATERMAINS SHALL BE EITHER DUCTILE IRON (DI) OR POLYETHYLENE (PE), WITH PE80 OR PE100 RATING (HDPE, HDPEOR HPPE). ALL PLASTIC WATER PIPES SHALL BE BLUE IN COLOUR.
 - ALL SERVICE CONNECTIONS TO BE 25# HDPE(SDR-17).
 - ALL WATERMAINS UNDER ROADS OR AT ROAD CROSSINGS TO BE HDPE OR DUCTILE IRON.
 - HDPE DISTRIBUTION PIPES TO BE PE-100(SDR-17).
 - DUCTILE IRON PIPES TO IS EN 545 WITH C40 POWER RATING.
 - AIR VALVE AND HYDRANTS COVERS, WHERE LOCATED IN GRASS AREAS, SHALL BE SURROUNDED BY A CONCRETE PLINTH, 200mm ALL ROUND AND 100mm DEEP FORMED WITH C20/25 CONCRETE, 20mm AGGREGATE SIZE, BEDDED IN CLAUSE 804 MATERIAL. THE PLINTH SHALL INCORPORATE MILD STEEL REINFORCED LINKS AND SHALL HAVE BULL-NOSE FINISH AROUND ITS EXTERNAL PERIMETER.
 - THRUST BLOCKS SHALL BE PROVIDED AT EACH BEND ALONG THE COURSE OF THE WATERMAIN.
 - PLANTING ADJACENT TO WATER INFRASTRUCTURE SHALL COMPLY WITH IRISH WATER STANDARD DETAIL STD-W-12A.
 - HORIZONTAL AND VERTICAL SERVICE LAYOUT DISTANCES SHALL BE AS PER IRISH WATER STANDARD DETAIL STD-W-11.
 - IT IS THE CONTRACTORS RESPONSIBILITY TO ENSURE THAT ALL WORKS ARE CONSTRUCTED IN ACCORDANCE WITH THE IRISH WATER CODE OF PRACTICE AND STANDARD DETAILS. THE CODE OF PRACTICE AND STANDARD DETAILS ARE AVAILABLE TO DOWNLOAD FROM THE IRISH WATER WEB SITE AT WWW.WATER.IE/CONNECTIONS/DEVELOPER-SERVICES/ WHERE THE DETAILS CONTAINED ON THIS DRAWING DIFFER FROM THE IRISH WATER CODE OF PRACTICE OR STANDARD DETAILS THIS MUST BE BROUGHT TO THE ATTENTION OF THE ENGINEER IMMEDIATELY. IRISH WATER STANDARDS WILL TAKE PRECEDENCE.

LEGEND:

- XXXmm ϕ PROPOSED 100# HDPE WATERMAIN WITH PIPE SIZE
- XXXmm ϕ PROPOSED 150# HDPE WATERMAIN WITH PIPE SIZE
- XXXmm ϕ EXISTING WATERMAIN WITH PIPE SIZE
- SV PROPOSED SLUICE VALVE
- H PROPOSED HYDRANT
- ScV PROPOSED SCOUR VALVE
- AV PROPOSED AIR VALVE
- NRV PROPOSED NON-RETURN VALVE
- M PROPOSED BULK WATER METER
- SWMH SURFACE WATER MANHOLE
- ScV NRV SWMH TYPICAL SCHEMATIC CONNECTION OF OFFLINE SCOUR VALVE
- PROPOSED BOUNDARY BOX AND CONNECTION
- LP ROAD LOW POINT
- HP ROAD HIGH POINT